

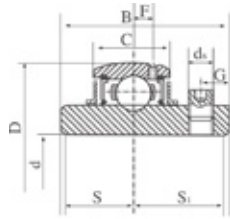

Insert bearings

外球面轴承



UC

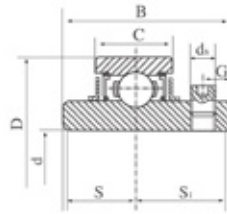

CUC



Bearing No. 轴承型号	Boundary Dimensions(mm inch) 外形尺寸									Basic Load Rating(N) 额定负荷		Weight 重量 Kg(pc)
	d	D	B	C	S	s1	G	dS	F	Dynamic Cr	Static Cor	
UC201	12	47 1.8504	31 1.2205	17 0.6693	12.7 0.5	18.3 0.72	4.8 0.189	M6×0.75 1/4-28UNF	3.7 0.146	9880	6200	0.2 0.19 0.19 0.19 0.18 0.17 0.16 0.16
UC201-8	1/2											
UC202	15											
UC202-9	9/16											
UC202-10	5/8											
UC203	17											
UC203-11	11/16											
UC204	20											
UC204-12	3/4											
UC205	25	52 2.0472	34.1 1.3425	17 0.6693	14.3 0.563	19.8 0.7795	5 0.197	M6×0.75 1/4-28UNF	3.9 0.154	10780	6980	0.2 0.24 0.23 0.21 0.2
UC205-13	13/16											
UC205-14	7/8											
UC205-15	15/16											
UC205-16	1											
UC206	30	62 2.4409	38.1 1.5	19 0.748	15.9 0.626	22.2 0.874	5 0.197	M6×0.75 1/4-28UNF	5 0.197	14970	10040	0.32 0.33 0.34 0.32 0.31
UC206-17	1-1/16											
UC206-18	1-1/8											
UC206-19	1-3/16											
UC206-20	1-1/4											
UC207	35	72 2.8346	42.9 1.689	20 0.7874	17.5 0.689	25.4 1	7 0.276	M8×1 5/16-24UNF	5.7 0.224	19750	13670	0.48 0.54 0.51 0.48 0.45
UC207-20	1-1/4											
UC207-21	1-5/16											
UC207-22	1-3/8											
UC207-23	1-7/16											
UC208	40	80 3.1496	49.2 1.937	21 0.8268	19 0.748	30.2 1.189	8 0.315	M8×1 5/16-24UNF	6.2 0.244	22710	19540	0.64 0.68 0.65
UC208-24	1-1/2											
UC208-25	1-9/16											
UC209	45	85 3.3465	49.2 1.937	22 0.8661	19 0.748	30.2 1.189	8 0.315	M8×1 5/16-24UNF	6.4 0.252	24360	17710	0.68 0.78 0.74 0.7
UC209-26	1-5/8											
UC209-27	1-11/16											
UC209-28	1-3/4											
UC210	50	90 3.5433	51.6 2.0315	24 0.9449	19 0.748	32.6 1.283	10 0.394	M10×1 3/8-24UNF	6.5 0.256	26980	19840	0.8 0.92 0.87 0.82 0.78
UC210-29	1-13/16											
UC210-30	1-7/8											
UC210-31	1-15/16											
UC210-32	2											

Insert bearings

外球面轴承

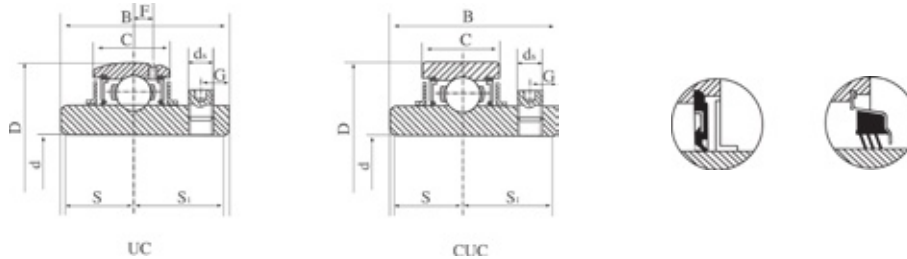

Bearing No. 轴承型号	Boundary Dimensions(mm inch) 外形尺寸									Basic Load Rating(N) 额定负荷		Weight 重量
	d	D	B	C	S	s1	G	dS	F	Dynamic Cr	Static Cor	Kg(pc)
UC211	55	100 3.937	55.6 2.189	25 0.9843	22.2 0.874	33.4 1.315	10 0.394	M10×1 3/8-24UNF	7 0.276	33370	25110	1.11
UC211-32	2											1.26
UC211-33	2-1/16											1.2
UC211-34	2-1/8											1.15
UC211-35	2-3/16											1.09
UC212	60	110 4.3307	65.1 2.563	27 1.063	25.4 1	39.7 1.563	10 0.394	M10×1 3/8-24UNF	7.6 0.299	36740	27970	1.54
UC212-36	2-1/4											1.67
UC212-37	2-5/6											1.59
UC212-38	2-3/8											1.52
UC212-39	2-7/16											1.45
UC213	65	120 4.3307	65.1 2.563	28 1.1024	25.4 1	39.7 1.563	10 0.394	M10×1 3/8-24UNF	8.5 0.335	44010	34180	1.85
UC213-40	2-1/2											1.94
UC213-41	2-9/16											1.85
UC214	70	125 4.9213	74.6 2.937	29 1.1417	30.2 1.189	44.4 1.748	12 0.472	M12×1.5 7/16-20UNF	8.9 0.35	46790	37590	2.05
UC214-42	2-5/8											2.26
UC214-43	2-11/16											2.16
UC214-44	2-3/4											2.06
UC215	75	130 5.1181	77.8 3.063	30 1.1811	33.3 1.311	44.5 1.752	12 0.472	M12×1.5 7/16-20UNF	9.2 0.362	50850	41260	2.21
UC215-45	2-13/16											2.46
UC215-46	2-7/8											2.35
UC215-47	2-15/16											2.24
UC215-48	3											2.12
UC216	80	140 5.5118	82.6 3.252	32 1.2598	33.3 1.311	49.3 1.9409	12 0.472	M12×1.5 7/16-20UNF	9.5 0.374	55040	45090	2.8
UC216-49	3-1/16											2.98
UC216-50	3-1/8											2.85
UC216-51	3-3/16											2.72
UC217	85	150 5.9055	85.7 3.374	34 1.3386	34.1 1.343	51.6 2.031	12 0.472	M12×1.5 7/16-20UNF	10.2 0.402	64010	53280	3.46
UC217-52	3-1/4											3.68
UC217-53	3-5/16											3.54
UC217-55	3-7/16											3.25
UC218	90	160 6.2992	96 3.7795	36 1.4173	39.7 1.563	56.3 2.217	12 0.472	M12×1.5 1/2-20UNF	11.2 0.441	73830	60760	4.36
UC218-56	3-1/16											4.47

Insert bearings

外球面轴承

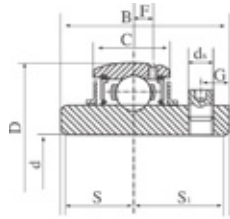

UC

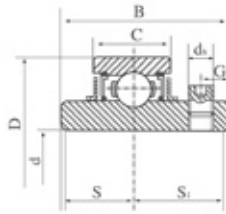

CUC



Bearing No. 轴承型号	Boundary Dimensions(mm inch) 外形尺寸									Basic Load Rating(N) 额定负荷		Weight 重量
	d	D	B	C	S	s1	G	dS	F	Dynamic Cr	Static Cor	Kg(pc)
UCX05	25	62 2.4409	38.1 1.5	19 0.748	15.9 0.626	22.2 0.874	5 0.197	M6×0.75 1/4-28UNF	5 0.197	14970	10040	0.39
UCX05-13	13/16											
UCX05-14	7/8											
UCX05-15	15/16											
UCX05-16	1											
UCX06	30	72 2.8346	42.9 1.689	20 0.7874	17.5 0.689	25.4 1	7 0.276	M8×1 5/16-24UNF	5.7 0.224	19750	13670	0.68
UCX06-17	1-1/16											
UCX06-18	1-1/8											
UCX06-19	1-3/16											
UCX07	35	80 3.1496	49.2 1.937	21 0.8268	19 0.748	30.2 1.189	8 0.315	M8×1 5/16-24UNF	6.2 0.244	22710	15940	0.82
UCX07-21	1-5/16											
UCX07-22	1-3/8											
UCX07-23	1-7/16											
UCX08	40	85 3.3465	49.2 1.937	22 0.8661	19 0.748	30.2 1.189	8 0.315	M8×1 5/16-24UNF	6.4 0.252	24360	17710	0.93
UCX08-24	1-1/2											
UCX08-25	1-9/16											
UCX09	45	90 3.5433	51.6 2.0315	24 0.9449	19 0.748	32.6 1.283	10 0.394	M10×1 3/8-24UNF	6.5 0.256	26980	19840	1
UCX09-26	1-5/8											
UCX09-27	1-11/16											
UCX09-28	1-3/4											
UCX10	50	100 3.937	55.6 2.189	25 0.9843	22.2 0.874	33.4 1.315	10 0.394	M10×1 3/8-24UNF	7 0.276	33370	25110	1.35
UCX10-30	1-7/8											
UCX10-31	1-15/16											
UCX11	55	110 4.3307	65.1 2.563	27 1.063	25.4 1	39.7 1.563	10 0.394	M10×1 3/8-24UNF	7.6 0.299	36740	27970	1.9
UCX11-33	2-1/16											
UCX11-34	2-1/8											
UCX11-35	2-3/16											

Insert bearings

外球面轴承

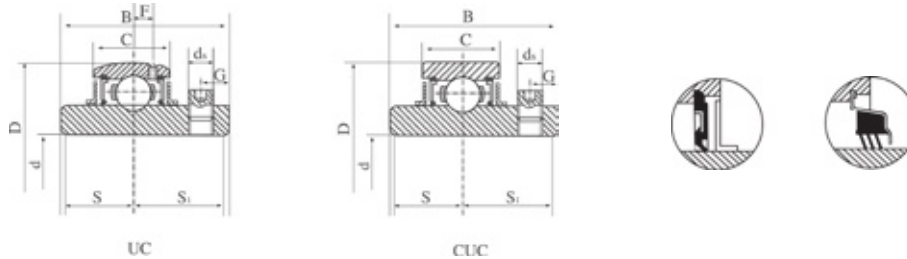

Bearing No. 轴承型号	Boundary Dimensions(mm inch) 外形尺寸									Basic Load Rating(N) 额定负荷		Weight 重量
	d	D	B	C	S	s1	G	dS	F	Dynamic Cr	Static Cor	Kg(pc)
UCX12	60	120 4.3307	65.1 2.563	28 1.1024	25.4 1	39.7 1.563	10 0.394	M10×1 3/8-24UNF	8.5 0.335	44010	34180	2.27
UCX12-38	2-3/8											
UCX12-39	2-7/16											
UCX13	65	125 4.9213	74.6 2.937	29 1.1417	30.2 1.189	44.4 1.748	12 0.472	M12×1.5 1/2-20UNF	8.9 0.35	46790	37590	2.45
UCX13-40	2-1/2											
UCX13-41	2-9/16											
UCX14	70	130 5.1181	77.8 3.063	30 1.1811	33.3 1.311	44.5 1.752	12 0.472	M12×1.5 1/2-20UNF	9.2 0.362	50850	41260	2.47
UCX14-42	2-3/8											
UCX14-43	2-11/16											
UCX14-44	2-3/4											
UCX15	75	140 5.5118	82.6 3.252	32 1.2598	33.3 1.311	49.3 1.9409	12 0.472	M12×1.5 1/2-20UNF	9.5 0.374	55040	45090	3.11
UCX15-45	2-13/16											
UCX15-46	2-7/8											
UCX15-47	2-15/16											
UCX215-48	3											
UCX16	80	150 5.9055	85.7 3.374	34 1.3386	34.1 1.343	51.6 2.031	12 0.472	M12×1.5 1/2-20UNF	10.2 0.402	64010	53280	3.79
UCX16-49	3-1/16											
UCX16-50	3-1/8											
UCX16-51	3-3/16											
UCX17	85	160 6.2992	96 3.7795	36 1.4173	39.7 1.563	56.3 2.217	12 0.472	M12×1.5 1/2-20UNF	11.2 0.441	73830	60760	4.82
UCX17-53	3-5/16											
UCX17-55	3-7/16											



Insert bearings

外球面轴承

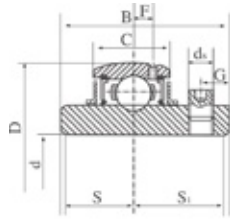

UC

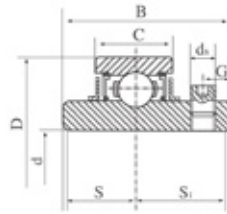

CUC



Bearing No. 轴承型号	Boundary Dimensions(mm inch) 外形尺寸									Basic Load Rating(N) 额定负荷		Weight 重量 Kg(pc)
	d	D	B	C	S	s1	G	dS	F	Dynamic Cr	Static Cor	
UC305	25	62 2.4409	38 1.4961	20 0.7874	15 0.591	23 0.906	6 0.236	M6×0.75 1/4-28UNF	5.4 0.213	17220	11930	0.35
UC305-13	13/16											0.4
UC305-14	7/8											0.38
UC305-15	15/16											0.36
UC305-16	1											0.35
UC306	30	72 2.8346	43 1.6929	23 0.9055	17 0.669	26 1.024	6 0.236	M6×0.75 1/4-28UNF	5.7 0.225	20770	14170	0.56
UC306-17	1-1/16											0.61
UC306-18	1-1/8											0.58
UC306-19	1-3/6											0.56
UC307	35	80 3.1496	48 1.8898	25 0.9843	19 0.748	29 1.142	8 0.315	M8×1 5/16-24UNF	6.2 0.244	25660	17920	0.71
UC307-20	1-1/4											0.77
UC307-21	1-5/16											0.74
UC307-22	1-3/8											0.71
UC307-23	1-7/16											0.68
UC308	40	90 3.5433	52 2.0472	27 1.063	19 0.748	33 1.299	10 0.394	M10×1 3/8-24UNF	7 0.276	31350	22380	0.96
UC308-24	1-1/2											1.01
UC308-25	1-9/16											0.97
UC309	45	100 3.937	57 2.2441	30 1.1811	22 0.866	35 1.378	10 0.394	M10×1 3/8-24UNF	7.8 0.307	40660	30000	1.28
UC309-26	1-5/8											1.39
UC309-27	1-11/16											1.35
UC309-28	1-3/4											1.3
UC310	50	110 4.3307	61 2.4016	32 1.2598	22 0.866	39 1.535	12 0.472	M12×1.5 1/2-20UNF	8.5 0.335	47580	35710	1.65
UC310-30	1-7/8											1.97
UC310-31	1-15/16											1.68
UC311	55	120 4.7244	66 2.5984	34 1.3386	25 0.984	41 1.614	12 0.472	M12×1.5 1/2-20UNF	9.2 0.362	55050	41910	2.07
UC311-32	2											2.25
UC311-33	2-1/16											2.18
UC311-34	2-1/8											2.12
UC311-35	2-3/16											2.04

Insert bearings

外球面轴承

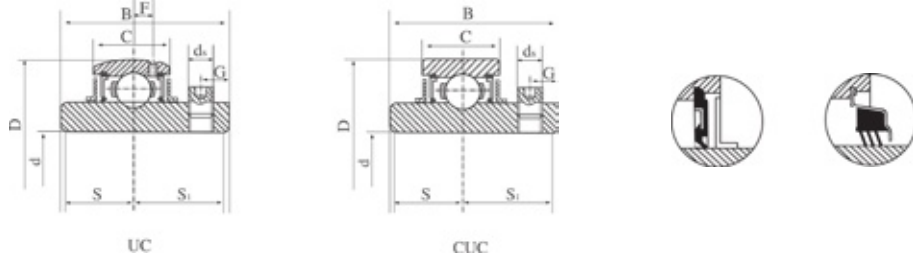

Bearing No. 轴承型号	Boundary Dimensions(mm inch) 外形尺寸									Basic Load Rating(N) 额定负荷		Weight 重量 Kg(pc)
	d	D	B	C	S	s1	G	dS	F	Dynamic Cr	Static Cor	
UC312	60	130 5.1181	71 2.7953	36 1.4173	26 1.0236	45 1.772	12 0.472	M12×1.5 1/2-20UNF	9.8 0.386	62880	48600	2.6
UC312-36	2-1/4											2.75
UC312-37	2-5/6											2.67
UC312-38	2-3/8											2.58
UC312-39	2-7/16											2.5
UC313	65	140 5.5118	75 2.9528	38 1.4961	30 1.181	45 1.772	12 0.472	M12×1.5 1/2-20UNF	10.5 0.413	72210	56680	3.25
UC313-40	2-1/2											3.34
UC313-41	2-9/16											3.24
UC314	70	150 5.9055	78 3.0708	40 1.5748	33 1.299	45 1.772	12 0.472	M12×1.5 1/2-20UNF	11.1 0.437	80100	63480	3.89
UC314-42	2-3/8											4.11
UC314-43	2-11/16											4
UC314-44	2-3/4											3.9
UC315	75	160 6.2992	82 3.2283	42 1.6535	32 1.26	50 1.969	14 0.551	M14×1.5 9/16-20UNF	11.8 0.465	87250	71670	4.72
UC315-45	2-13/16											4.99
UC315-46	2-7/8											4.85
UC315-47	2-15/16											4.76
UC315-48	3											4.63
UC316	80	170 6.6929	86 3.3858	44 1.7323	34 1.339	52 2.047	14 0.551	M14×1.5 9/16-20UNF	12.5 0.492	94570	80350	5.55
UC316-49	3-1/16											5.72
UC316-50	3-1/8											5.58
UC316-51	3-3/16											5.49
UC317	85	180 7.0866	96 3.7795	46 1.811	40 1.575	56 2.205	16 0.63	M16×1.5 5/8-20UNF	13.1 0.516	102050	89520	6.67
UC317-52	3-1/4											6.89
UC317-53	3-5/16											6.76
UC317-55	3-7/16											6.44
UC318	90	190 7.4803	96 3.7795	48 1.8898	40 1.575	56 2.05	16 0.63	M16×1.5 5/8-20UNF	13.8 0.543	110810	100760	7.56
UC318-55	3-7/16											7.85
UC318-56	3-1/2											7.67
UC319	95	200	103	50	41	62	16	M16×1.5				

Insert bearings

外球面轴承

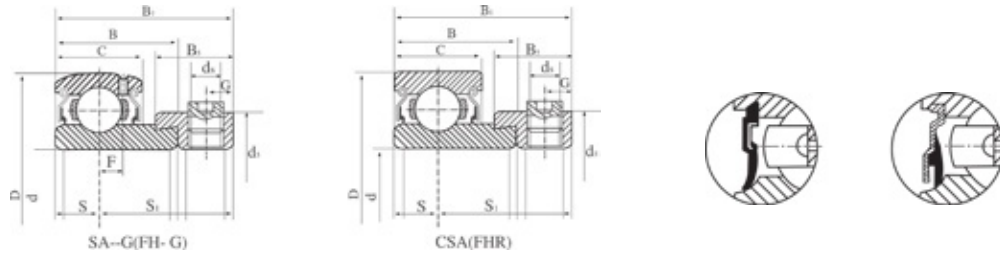

Bearing No. 轴承型号	Boundary Dimensions(mm inch) 外形尺寸										Basic Load Rating(N) 额定负荷		Weight 重量
	d	D	B1	B	C	S	ds	G	B5	ds	Dynamic Cr	Static Cor	Kg(pc)
SA201	12	40	28.6	19.1	12	6.5	M6×0.75	4.8	13.5	28.6	7360	4480	0.12
SA201-8	3/4	1.5748	1.126	0.752	0.4724	0.256	1/4-28UNF	0.189	0.531	1.126			0.12
SA202	15	47 1.5748	28.6 1.126	19.1 0.752	12 0.4724	6.5 0.256	M6×0.75 1/4-28UNF	4.8 0.189	13.5 0.531	28.6 1.126	7360	4480	0.1
SA202-9	9/16												0.1
SA202-10	5/8												0.1
SA203	17	47 1.5748	28.6 1.126	19.1 0.752	12 0.4724	6.5 0.256	M6×0.75 1/4-28UNF	4.8 0.189	13.5 0.531	28.6 1.126	7360	4480	0.09
SA203-11	11/16												0.09
SA204	20	47 1.8504	31 1.22	21.5 0.8465	14 0.5512	7.5 0.295	M6×0.75 1/4-28UNF	4.8 0.189	13.5 0.531	33.3 1.311	9880	6200	0.16
SA204-12	3/4												0.16
SA205	25	52 2.0472	31 1.22	21.5 0.8465	15 0.596	7.5 0.295	M6×0.75 1/4-28UNF	4.8 0.189	13.5 0.531	38.1 1.5	10780	6980	0.2
SA205-13	13/16												0.22
SA205-14	7/8												0.21
SA205-15	15/16												0.21
SA205-16	1												0.2
SA206	30	62 2.4409	35.7 1.406	23.8 0.937	16 0.6299	9 0.354	M6×0.75 1/4-28UNF	6 0.236	15.9 0.626	44.5 1.752	14970	10040	0.3
SA206-17	1-1/16												0.32
SA206-18	1-1/8												0.31
SA206-19	1-3/16												0.3
SA206-20	1-1/4												0.29
SA207	35	72 2.8346	38.9 1.531	25.4 1	17 0.6693	9.5 0.374	M8×1 5/16-28UNF	6.8 0.268	17.5 0.689	55.6 2.189	19750	13670	0.42
SA207-20	1-1/4												0.46
SA207-21	1-5/16												0.43
SA207-22	1-3/8												0.42
SA207-23	1-7/16												0.41



Insert bearings

外球面轴承

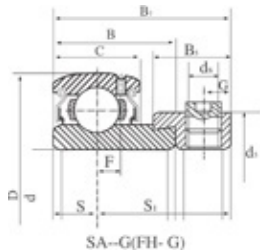

SA-G(FH-G)

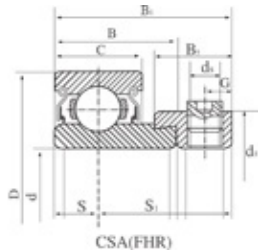

CSA(FHR)



Bearing No. 轴承型号	Boundary Dimensions(mm inch) 外形尺寸										Basic Load Rating(N) 额定负荷		Weight 重量
	d	D	B1	B	C	S	ds	G	B5	ds	Dynamic Cr	Static Cor	Kg(pc)
SA208	40	80 3.1496	43.7 1.721	30.2 1.189	18 0.7087	11 0.433	M8×1 5/16-24UNF	6.8 0.268	18.3 0.72	60.3 2.374	22710	15940	0.6
SA208-24	1-1/2												0.58
SA208-25	1-9/16												0.6
SA209	45	85 3.3465	43.7 1.721	30.2 1.189	19 0.748	11 0.433	M8×1 5/16-24UNF	6.8 0.268	18.3 0.72	63.5 2.5	24360	17710	0.76
SA209-26	1-5/8												
SA209-27	1-11/16												
SA209-28	1-3/4												
SA210	50	90 3.5433	43.7 1.721	30.2 1.189	20 0.7874	11 0.433	M8×1 5/16-24UNF	6.8 0.268	18.3 0.72	69.9 2.752	26980	19840	0.91
SA210-29	1-13/16												
SA210-30	1-7/8												
SA210-31	1-15/16												
SA210-32	2												
SA211	55	100 3.937	48.4 1.906	32.5 1.2795	21 0.8268	12 0.472	M8×1 5/16-24UNF	8 0.315	20.7 0.815	76.2 3	33370	25110	1.26
SA211-32	2												
SA211-33	2-1/16												
SA211-34	2-1/8												
SA211-35	2-3/16												
SA212	60	110 4.3307	53.1 2.091	37.2 1.4646	22 0.8661	13.5 0.532	M10×1 3/8-24UNF	8 0.315	22.3 0.878	84.2 3.315	36740	27970	1.7
SA212-36	2-1/4												
SA212-37	2-5/16												
SA212-38	2-3/8												
SA212-39	2-7/16												

Insert bearings

外球面轴承

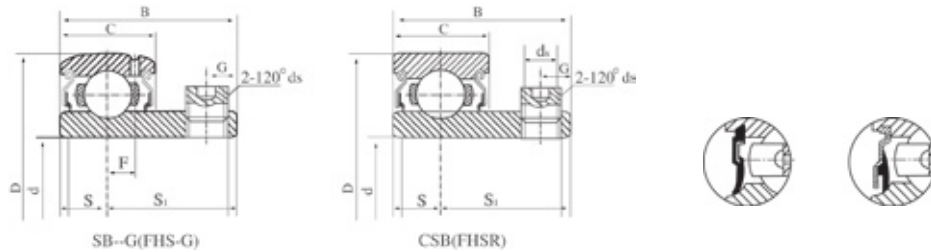

Bearing No. 轴承型号	Boundary Dimensions(mm inch) 外形尺寸								Basic Load Rating(N) 额定负荷		Weight 重量 Kg(pc)
	d	D	B	C	S	S1	ds	G	Dynamic Cr	Static Cor	
SB201	12	40	22	12	6	16	M6×0.75	4.5	7360	4480	0.12
SB201-8	3/4	1.5748	0.8661	0.4724	0.236	0.63	1/4-28UNF	0.177			0.12
SB202	15	47 1.5748	22 0.8661	12 0.4724	6 0.236	16 0.63	M6×0.75 1/4-28UNF	4.5 0.177	7360	4480	0.1
SB202-9	9/16										0.1
SB202-10	5/8										0.1
SB203	17	47 1.5748	22 0.8661	12 0.4724	6 0.236	16 0.63	M6×0.75 1/4-28UNF	4.5 0.177	7360	4480	0.09
SB203-11	11/16										0.09
SB204	20	47 1.8504	25 0.9843	14 0.5512	7 0.276	18 0.709	M6×0.75 1/4-28UNF	4.5 0.177	9880	6200	0.16
SB204-12	3/4										0.16
SB205	25	52 2.0472	27 1.063	15 0.5906	7.5 0.295	19.5 0.766	M6×0.75 1/4-28UNF	5.5 0.217	10780	6980	0.2
SB205-13	13/16										0.22
SB205-14	7/8										0.21
SB205-15	15/16										0.21
SB205-16	1										0.2
SB206	30	62 2.4409	30 1.1811	16 0.6299	8 0.315	22 0.866	M6×0.75 1/4-28UNF	6 0.236	14970	10040	0.3
SB206-17	1-1/16										0.32
SB206-18	1-1/8										0.31
SB206-19	1-3/8										0.3
SB206-20	1-1/4										0.29
SB207	35	72 2.8346	32 1.2598	17 0.6693	8.5 0.335	23.5 0.925	M8×1 5/16-24UNF	6.5 0.256	19750	13670	0.42
SB207-20	1-1/4										0.46
SB207-21	1-5/16										0.43
SB207-22	1-3/8										0.42
SB207-23	1-7/16										0.41

Insert bearings

外球面轴承

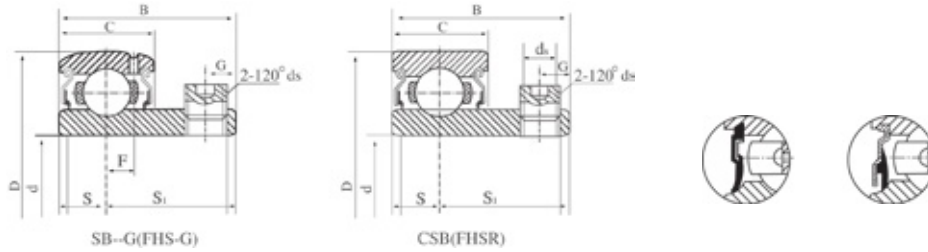

Bearing No. 轴承型号	Boundary Dimensions(mm inch) 外形尺寸								Basic Load Rating(N) 额定负荷		Weight 重量 Kg(pc)
	d	D	B	C	S	S1	ds	G	Dynamic Cr	Static Cor	
SB208	40	80 3.1496	34 1.3386	18 0.7087	9 0.354	25 0.984	M8×1 5/16-24UNF	7 0.276	22710	15940	0.6
SB208-24	1-1/2										0.58
SB208-25	1-9/16										0.6
SB209	45	85 3.3465	41.2 1.622	19 0.748	10.2 0.402	31 1.22	M8×1 5/16-24UNF	8.2 0.323	24360	17710	0.76
SB209-26	1-5/8										
SB209-27	1-11/16										
SB209-28	1-3/4										
SB210	50	90 3.5433	43.5 1.7126	20 0.7874	10.9 0.429	32.6 1.283	M10×1 3/8-24UNF	9.2 0.362	26980	19840	0.91
SB210-29	1-13/16										
SB210-30	1-7/8										
SB210-31	1-15/16										
SB210-32	2										
SB211	55	100 3.937	45.3 1.7835	21 0.8268	11.8 0.465	33.5 1.319	M10×1 3/8-24UNF	9.8 0.386	33370	25110	1.26
SB211-32	2										
SB211-33	2-1/16										
SB211-34	2-1/8										
SB211-35	2-3/16										
SB212	60	110 4.3307	53.7 2.1142	22 0.8661	14.9 0.587	38.8 1.528	M10×1 3/8-24UNF	9.2 0.386	36740	27970	1.7
SB212-36	2-1/4										
SB212-37	2-5/16										
SB212-38	2-3/8										
SB212-39	2-7/16										

### Insert bearings

外球面轴承

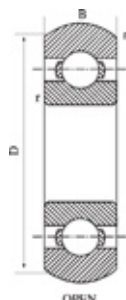

Bearing No. 轴承型号	Boundary Dimensions(mm) 外形尺寸			Basic Load Rating(N) 额定负荷		Weight 重量
	d	D	B	Dynamic Cr	Static Cor	Kg(pc)
SC200	10	30	9	520	245	0.03
SC201	12	32	10	690	310	0.035
SC202	15	35	11	780	380	0.04
SC203	17	40	12	7360	4480	0.06
SC204	20	47	14	9880	6200	0.1
SC205	25	52	15	10780	6980	0.13
SC206	30	62	16	14970	10040	0.2
SC207	35	72	17	19750	13670	0.29
SC208	40	80	18	22710	15940	0.37
SC209	45	85	19	24360	17710	0.46
SC210	50	90	20	26980	19840	0.57

Insert bearings

外球面轴承

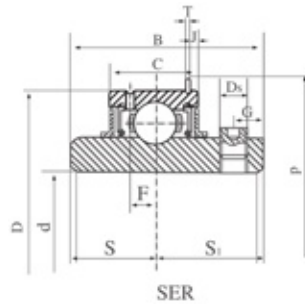

Bearing No. 轴承型号	Boundary Dimensions(mm inch) 外形尺寸												Basic Load Rating(N) 额定负荷		Weight 重量
	d	D	B	C	S	S1	T	F	J	P	G	ds	Dynamic Cr	Static Cor	Kg (pc)
SER204	20	47	31	15.9	10.3	20.7	1.12	3.8	2.46	52.7	4.8	M6×0.75	9880	6200	0.21
SER204-12	3/4	1.8504	1.2205	0.626	0.406	0.815	0.044	0.15	0.097	2.075	0.189	1/4-28UNF			
SER205	25	52 2.0472	34.9 1.374	19 0.748	13.1 0.516	21.8 0.858	1.12 0.044	5.2 0.205	2.46 0.097	57.9 2.28	5 0.197	M6×0.75 1/4-28UNF	10780	6980	0.27
SER205-13	13/16														
SER205-14	7/8														
SER205-15	15/16														
SER205-16	1														
SER206	30	62 2.4409	38.1 1.5	22.2 0.874	15.9 0.626	22.2 0.874	1.7 0.067	5.6 0.22	3.28 0.129	67.7 2.665	5 0.197	M6×0.75 1/4-28UNF	14970	10040	0.39
SER206-17	1-1/16														
SER206-18	1-1/8														
SER206-19	1-3/16														
SER206-20	1-1/4														
SER207	35	72 2.8346	42.9 1.689	23.8 0.937	17.5 0.689	25.4 1	1.7 0.067	5.6 0.22	3.28 0.129	78.6 3.094	6.7 0.264	M8×1 5/16-24UNF	19750	13670	0.63
SER207-20	1-1/4														
SER207-21	1-5/16														
SER207-22	1-3/8														
SER207-23	1-7/16														
SER208	40	80 3.1496	49.2 1.937	27.8 1.0945	19 0.748	30.2 1.189	1.7 0.067	6.4 0.252	3.28 0.129	86.6 3.409	8 0.315	M8×1 5/16-24UNF	22710	15940	0.81
SER208-24	1-1/2														
SER208-25	1-9/16														
SER209	45	85 3.3465	49.2 1.937	27.8 1.0945	19 0.748	30.2 1.189	1.7 0.067	6.4 0.252	3.28 0.129	91.6 3.606	8 0.315	M8×1 5/16-24UNF	24360	17710	0.9
SER209-26	1-5/8														
SER209-27	1-11/16														
SER209-28	1-3/4														
SER210	50	90 3.5433	51.6 2.0315	28.6 1.126	19 0.748	32.6 1.283	2.46 0.097	7.5 0.295	3.28 0.129	96.5 3.799	10 0.394	M10×1 3/8-24UNF	26980	19840	0.98
SER210-29	1-13/16														
SER210-30	1-7/8														
SER210-31	1-15/16														
SER210-32	2	100 3.937	55.6 2.189	30.2 1.189	22.2 0.874	33.4 1.315	2.46 0.097	7.5 0.295	3.28 0.129	106.5 4.193	10 0.394	M10×1 3/8-24UNF	33370	25110	1.4
SER211	55														
SER211-32	2														
SER211-33	2-1/16														
SER211-34	2-1/8														
SER211-35	2-3/16														
SER212	60	110 4.3307	65.1 2.563	31.8 1.252	25.4 1	39.7 1.563	2.46 0.097	7.5 0.295	3.28 0.129	116.6 4.591	10 0.394	M10×1 3/8-24UNF	36740	27970	1.89
SER212-36	2-1/4														
SER212-37	2-5/16														
SER212-38	2-3/8														
SER212-39	2-7/16														

Insert bearings

外球面轴承

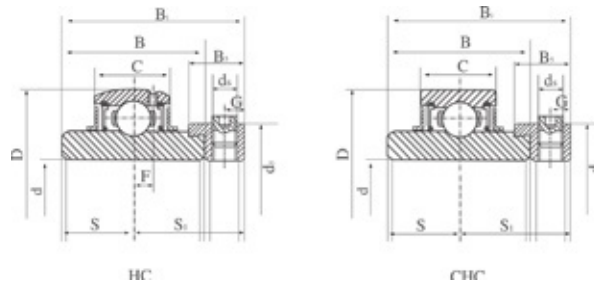

Bearing No. 轴承型号	Boundary Dimensions(mm inch) 外形尺寸											Basic Load Rating(N) 额定负荷		Weight 重量 Kg (pc)
	d	D	B1	B	C	S	Ds	G	B5	d3	F	Dynamic Cr	Static Cor	
	HC204	20	47	43.7	34.2	17	17.1	M6×0.75	4.8	13.5	33.3	3.7	9880	
HC204-12	3/4	1.8504	1.72	1.3465	0.6693	0.673	1/4-28UNF	0.189	0.531	1.311	0.146	0.23		
HC205	25	52 2.0472	44.4 1.748	34.9 1.374	17 0.6693	17.5 0.689	M6×0.75 1/4-28UNF	4.8 0.189	13.5 0.531	38.1 1.5	3.9 0.154	10780	6980	0.27
HC205-13	13/16													0.32
HC205-14	7/8													0.31
HC205-15	15/16													0.29
HC05-16	1													0.27
HC206	30	62 2.4409	48.4 1.906	36.5 1.437	19 0.748	18.3 0.72	M8×1 5/16-24UNF	6 0.236	15.9 0.626	44.5 1.752	5 0.197	14970	10040	0.45
HC206-17	1-1/16													0.5
HC206-18	1-1/8													0.47
HC06-19	1-3/16													0.45
HC06-20	1-1/4													0.42
HC207	35	72 2.8346	51.1 2.012	37.6 1.4803	20 0.7874	18.8 0.74	M8×1 5/16-24UNF	6.8 0.268	17.5 0.689	55.6 2.189	5.7 0.224	19750	13670	0.6
HC07-20	1-1/4													0.67
HC07-21	1-5/16													0.63
HC07-22	1-3/8													0.6
HC07-23	1-7/16													0.57
HC208	40	80 3.1496	56.3 2.217	42.8 1.685	21 0.8268	21.4 0.843	M8×1 5/16-24UNF	6.8 0.268	18.3 0.72	60.3 2.374	6.2 0.244	22710	15940	0.79
HC208-24	1-1/2													0.84
HC208-25	1-9/16													0.8
HC209	45	85 3.3465	56.3 2.217	42.8 1.685	22 0.8661	21.4 0.843	M8×1 5/16-24UNF	6.8 0.268	18.3 0.72	63.5 2.5	6.2 0.252	24360	17710	0.85
HC209-26	1-5/8													0.96
HC209-27	1-11/16													0.91
HC209-28	1-3/4													0.87
HC210	50	90 3.5433	62.7 2.469	49.2 1.937	24 0.9449	24.6 0.969	M8×1 5/16-24UNF	6.8 0.268	18.3 0.72	69.9 2.752	6.5 0.256	26980	19840	0.99
HC210-29	1-13/16													1.14
HC210-30	1-7/8													1.08
HC210-31	1-15/16													1.02
HC210-32	2													0.96



Insert bearings

外球面轴承

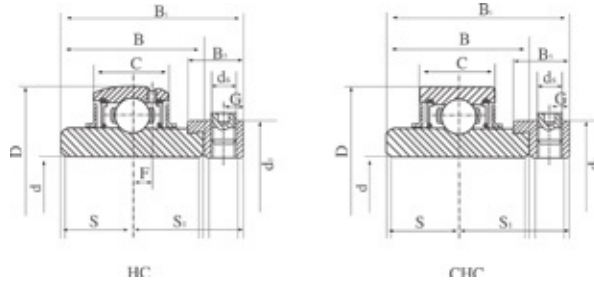

Bearing No. 轴承型号	Boundary Dimensions(mm inch) 外形尺寸											Basic Load Rating(N) 额定负荷		Weight 重量 Kg (pc)
	d	D	B1	B	C	S	Ds	G	B5	d3	F	Dynamic	Static	
												Cr	Cor	
HC211	55	100 3.937	71.4 2.811	55.5 2.185	25 0.9843	27.8 1.094	M8×1 5/16-24UNF	8 0.315	20.7 0.815	76.2 3	7 0.276	33370	25110	1.32
HC211-32	2													1.52
HC211-33	2-1/16													1.44
HC211-34	2-1/8													1.37
HC211-35	2-3/16													1.29
HC212	60	110 4.3307	77.8 3.063	61.9 2.437	27 1.063	31 1.22	M10×1 3/8-24UNF	8 0.315	22.3 0.878	84.2 3.315	7.6 0.299	36740	27970	1.88
HC212-36	2-1/4													2.04
HC212-37	2-5/16													1.95
HC212-38	2-3/8													1.9
HC212-39	2-7/16													1.77
HC213	65	120 4.7244	85.7 33.74	68.6 2.7008	28 1.1024	34.1 1.343	M10×1 3/8-24UNF	8.5 0.335	23.5 0.925	86 3.386	8.5 0.335	440170	34180	2.41
HC213-40	2-1/2													2.51
HC213-41	2-9/16													2.4
HC214	70	125 4.9213	85.7 3.374	68.6 2.7008	29 1.1417	34.1 1.343	M10×1 3/8-24UNF	8.5 0.335	23.5 0.925	90 3.543	8.9 0.35	46790	37590	2.55
HC214-42	2-3/8													2.79
HC214-43	2-11/16													2.68
HC214-44	2-3/4													2.56
HC215	75	130 5.1181	92.1 3.626	75 2.9528	30 1.1811	37.3 1.469	M10×1 3/8-24UNF	8.5 0.335	23.5 0.925	102 4.016	9.2 0.362	50850	41260	2.84
HC215-45	2-13/16													3.14
HC215-46	2-7/8													3.01
HC215-47	2-15/16													2.88
HC215-48	3													2.74

Insert bearings

外球面轴承

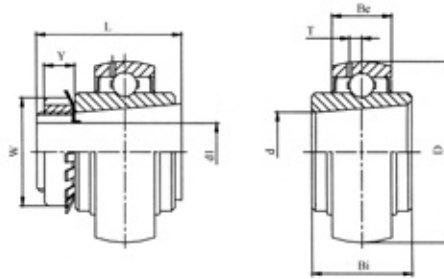

Bearing No. 轴承型号	Boundary Dimensions(mm inch) 外形尺寸										Basic Load Rating(N) 额定负荷		Weight 重量
	Shaft Dia d1		D	L	d	Bi	Be	T	y	w	Dynamic Cr	Static Cor	Kg(pc)
	(in)	(mm)											
UK205+HE2305	3/4		52	35	25	23	17	4.5	8	38	10780	6980	0.25
UK205+HA2305	13/16												0.24
UK205+H2305		20											0.24
UK206+HS2306	7/8		62	38	30	26	19	5.1	8	45	14970	10040	0.42
UK206+HA2306	15/16												0.41
UK206+HE2306	1												0.37
UK206+H2306		25											0.4
UK207+HS2307	1-1/8		72	43	35	27	20	5.8	9	52	19750	13670	0.57
UK207+HA2307	1-3/16												0.55
UK207+H2307		30											0.55
UK208+HE2308	1-1/4		80	46	40	29	21	6.2	10	58	22710	15940	0.78
UK208+HA2308	1-5/16												0.75
UK208+HS2308	1-3/8												0.72
UK208+H2308		35											0.72
UK209+HA2309	1-7/16		85	50	45	30	22	6.5	11	65	24360	17710	0.89
UK209+HE2309	1-1/2												0.84
UK209+HS2309	1-5/8												0.77
UK209+H2309		40											0.8
UK210+HA2310	1-11/16		90	55	50	31	23	6.5	12	70	26980	19840	0.98
UK210+HE2310	1-3/4												0.95
UK210+H2310		45											0.93

Insert bearings

外球面轴承

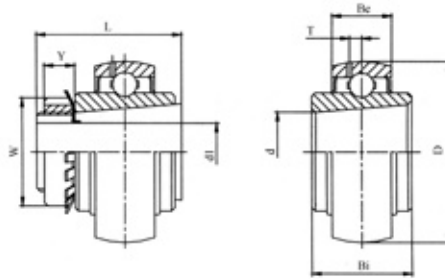

Bearing No. 轴承型号	Boundary Dimensions(mm inch) 外形尺寸										Basic Load Rating(N) 额定负荷		Weight 重量
	Shaft Dia d1		D	L	d	Bi	Be	T	y	w	Dynamic Cr	Static Cor	Kg(pc)
	(in)	(mm)											
UK211+HS2311	1-7/8		100	59	55	33	24	7.3	12	75	33370	25110	1.28
UK211+HA2311	1-15/16												1.22
UK211+HE2311	2												1.17
UK211+H2311		50											1.19
UK212+HA2312	2-1/16		110	62	60	36	26	7.7	13	80	36740	27970	1.62
UK212+HS2312	2-1/8												1.56
UK212+H2312		55											1.52
UK213+HA2313	2-3/16		120	65	65	38	27	8.3	14	85	44010	34180	2.1
UK213+HE2313	2-1/4												2.04
UK213+HS2313	2-3/8												1.89
UK213+H2313		60											1.91
UK215+HA2315	2-1/2		130	73	75	41	30	9.2	15	98	50850	41260	2.65
UK215+H2315		65											2.56
UK216+HE2316	2-3/4		140	78	80	44	32	9.6	17	105	55040	45090	3.24
UK216+H2316		70											3.23
UK217+HE2317	3		150	82	85	46	34	10.5	18	110	64010	53280	3.84
UK217+H2317		75											3.93
UK218+HS2318	3-1/8		160	86	90	49	36	11.1	18	120	73830	60760	4.8
UK218+H2318		80											4.75

Table 1. Fit Tolerances

表1 配合公差

Unit:  $\mu\text{m}$

Diameter D (mm)	H6		H7		H8		H12		h7		h8		h12		J6		J7		K6		K7		
	over	incl	high	low	high	low	high	low	high	low	high	low	high	low	high	low	high	low	high	low	high	low	
18	30	+13	0	+21	0	+33	0	+210	0	0	-21	0	-33	0	-210	+8	-5	+12	-9	+2	-11	6	-15
30	50	+16	0	+25	0	+39	0	+250	0	0	-25	0	-39	0	-250	+10	-6	+14	-11	+3	-13	7	-18
50	80	+19	0	+30	0	+46	0	+300	0	0	-30	0	-46	0	-300	+13	-6	+18	-12	+4	-15	9	-21
80	120	+22	0	+35	0	+54	0	+350	0	0	-35	0	-54	0	-350	+16	-6	+22	-13	+4	-18	10	-25
120	180	+25	0	+40	0	+63	0	+400	0	0	-40	0	-63	0	-400	+18	-7	+26	-14	+4	-21	12	-28
180	250	+29	0	+46	0	+72	0	+460	0	0	-46	0	-72	0	-460	+22	-7	+30	-16	+5	-24	13	-33
250	315	+32	0	+52	0	+81	0	+520	0	0	-52	0	-81	0	-520	+25	-7	+36	-16	+5	-27	16	-36
315	400	+36	0	+57	0	+89	0	+570	0	0	-57	0	-89	0	-570	+29	-7	+39	-18	+7	-29	17	-40
400	500	+40	0	+63	0	+97	0	+630	0	0	-63	0	-97	0	-630	+33	-7	+43	-20	+8	-32	18	-45

Table 2. T Type housing Tolerances

表2 T型座子公差

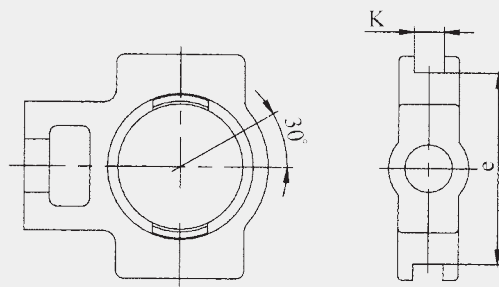

Unit:  $\mu\text{m}$

Housing No			K		e	
T			higt	low	higt	low
204			+200	0	0	-500
205	305	X05				
206	306	X06				
207	307	X07				
208	308	X08				
209	309	X09				
210	310	X10				
211	311	X11				
212	312	X12				
213	313	X13				
214	314	X14	+300	0	0	-800
215	315	X15				
216	316	X16				
217	317	X17				
218	318					
	319					
	320					
	321					
	322					
	324					
	326					
	328					

Table 3. C Type housing Tolerances

表3 C型座子公差

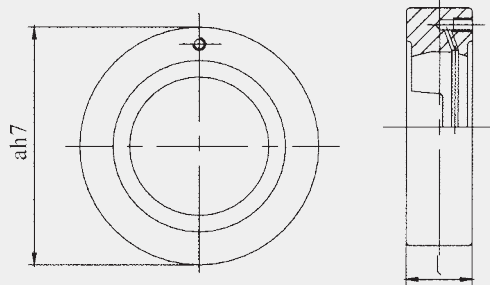

Unit:  $\mu\text{m}$

Housing No			Tolerance of a						Tolerance of outside diameter run-out(maximum)	Tolerance of l
			C2..		C3..		CX..			
			max	min	max	min	max	min		
C204			0	-30	/	/	/	/	200	$\pm 200$
C205	C305	CX05			0	-35	0	-35		
C206	C306	CX06								
C207	C307	CX07								
C208	C308	CX08	0	-35						
C209	C309	CX09								
C210	C310	CX10					0	-40	300	$\pm 300$
C211	C311	CX11			0	-40				
C212	C312	CX12	0	-40						
C213	C313									
	C314									
	C315	--								
	C316	--								
	C317	--			0	-46				
	C318	--					/	/		
	C319	--	/	/						
	C320	--			0	-52				
	C322	--								
	C324	--								
	C326	--			0	-57				
	C328									
								400		

**Table 4. Flange Housing Tolerances**

表4 法兰座子公差

Unit:  $\mu\text{m}$

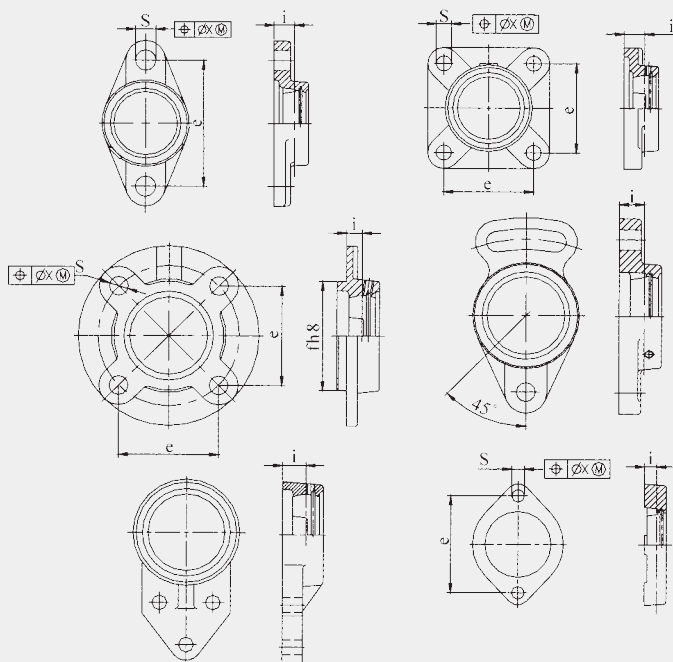

HousingsNo			i		e					
F FL	F FL	F FL	high	low	high	low				
LF FC	FS	FC								
203	305	X05	+500	-500	+700	-700				
204	306	X06								
205	307	X07								
206	308	X08								
207	309	X09								
208	310									
209										
210										
211	311	X10					+800	-800	+1000	+1000
212	312	X11								
213	313	X12								
214	314	X13								
215	315	X14								
216	316	X15								
217	317	X16								
218	318	X17								
	319	X18								
	320	X20								
	321									
	322									
	324									
	326									
	328									

**Table 5. Pillow block Tolerances**

表5 P LP PA型座子公差

Unit:  $\mu\text{m}$

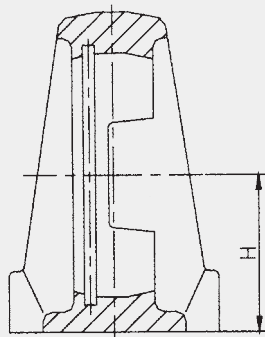

Housing No		Tolerance H
P203-210	P305-P310	$\pm 0.15$
LP203-210	PE203-210	
PA203-20		
P211-218	P311-319	$\pm 0.20$
LP211-213	PE211-215	
PA211-213		
	P320-328	$\pm 0.30$



**Table 6. Punching Housing Tolerances**

表6 冲压座子公差

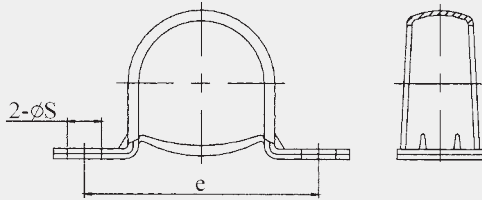

Unit:  $\mu\text{m}$

Housing No	Tolerances	
	e	S
PP203	±400	±500
PP204		
PP205		
PP206		
PP207		

**Table 7. Punching Housing Tolerances**

表7 冲压座子公差

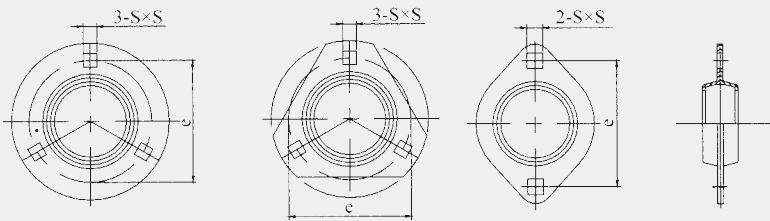

Unit:  $\mu\text{m}$

Housing No	Tolerances	
	e	S
PF203 PFL203	±400	±250
PFT203		
PF204 PFL204		
PFT204		
PF205 PFL205		
PFT205		
PF206 PFL206		
PFT206		
PF207 PFL207		
PFT207		

**Table8. P0 Grade Self-aligning Bearing Inner Ring Tolerance  
(Except for Tapered Roller Bearings)**

表8 P0级向心轴承内圈公差（圆锥滚子轴承除外）

Unit:  $\mu\text{m}$

d(mm)		$\Delta\text{dmp}$		Vdp			$\Delta\text{dmp}$	Kia	$\Delta\text{Bs}$		VBs
				Dia. Series 直径系列							
				8,9	0,1	2,3,4					
Over 超过	To 到	Up 上偏差	Down 下偏差		Max. 最大		Max. 最大	Max. 最大	Up 上偏差	Down 下偏差	Max. 最大
	10	0	-8	10	8	6	6	10	0	-120	15
10	18	0	-8	10	8	6	6	10	0	-120	20
18	30	0	-10	13	10	8	8	13	0	-120	20
30	50	0	-12	15	12	9	9	15	0	-120	20
50	80	0	-15	19	19	11	11	20	0	-150	25
80	120	0	-20	25	25	15	15	25	0	-200	25
120	180	0	-25	31	31	19	19	30	0	-250	30
180	250	0	-30	38	38	23	23	40	0	-300	30
250	315	0	-35	44	44	26	26	50	0	-350	35
315	400	0	-40	50	50	30	30	60	0	-400	40
400	500	0	-45	56	56	34	34	65	0	-450	50
500	630	0	-50	63	63	38	38	70	0	-500	60
630	800	0	-75	-	-	-	-	80	0	-750	70
800	1000	0	-100	-	-	-	-	90	0	-1000	80
1000	1250	0	-125	-	-	-	-	100	0	-1250	100
1250	1600	0	-160	-	-	-	-	120		-1600	120

**Table 9. P0 Grade Self-aligning Bearing Outer Ring Tolerance  
(Except for Tapered Roller Bearings)**

表9 P0级向心轴承外圈公差（圆锥滚子轴承除外）

Unit:  $\mu\text{m}$

D(mm)		$\Delta\text{Dmp}$		Vdp				Vdmp	Kea	$\Delta\text{Cs}$		VCs
				Open Typed 开型轴承		Close 闭型轴承						
				Dia. Series 直径系列								
9	0,1	2,3,4	2,3,4					Up 上偏差	Down 下偏差	Max. 最大		
Over 超过	To 到	Up 上偏差	Down 下偏差		Max. 最大		Max. 最大	Max. 最大	Up 上偏差	Down 下偏差	Max. 最大	
18	30	0	-9	12	9	7	12	7	15			
30	50	0	-11	14	11	8	16	8	20			
50	80	0	-13	16	13	10	20	10	25			
80	120	0	-15	19	19	11	26	11	35			
120	150	0	-18	23	23	14	30	14	40			
150	180	0	-25	31	31	19	38	19	45			
180	250	0	-30	38	38	23	-	23	50			
250	315	0	-35	44	44	26	-	26	60			
315	400	0	-40	50	50	30	-	30	70			
400	500	0	-45	56	56	34	-	34	80			
500	630	0	-50	63	63	38	-	38	100			
630	800	0	-75	94	94	55	-	55	120			
800	1000	0	-100	125	125	75	-	75	140			
1000	1250	0	-125	-	-	-	-	-	160			
1250	1600	0	-160	-	-	-	-	-	190			
1600	2000	0	-200	-	-	-	-	-	220			
2000	2500	0	-250	-	-	-	-	-	250			

Equals to  $\Delta\text{Bs}$  and  $\text{Vbs}$  of the same bearing inner ring.  
与同一轴承内圈的 $\Delta\text{Bs}$ 及 $\text{Vbs}$ 相同

**Table10. P6 Grade Self-aligning Bearing Inner Ring Tolerance (Except for Tapered Roller Bearings)**

表10 P6级向心轴承内圈公差（圆锥滚子轴承除外）

Unit:  $\mu\text{m}$

d(mm)		$\Delta\text{dmp}$		Vdp			$\Delta\text{dmp}$	Kia	$\Delta\text{Bs}$		VBs
				Dia. Series							
				9	0,1	2,3,4					
Over 超过	To 到	Up 上偏差	Down 下偏差		Max. 最大		Max. 最大	Max. 最大	Up 上偏差	Down 下偏差	Max. 最大
2.5	10	0	-7	9	7	5	5	6	0	-120	15
10	18	0	-7	9	7	5	5	7	0	-120	20
18	30	0	-8	10	8	6	6	8	0	-120	20
30	50	0	-10	13	10	8	8	10	0	-120	20
50	80	0	-12	15	15	9	9	10	0	-150	25
80	120	0	-15	19	19	11	11	13	0	-200	25
120	180	0	-18	23	23	14	14	18	0	-250	30
180	250	0	-22	28	28	17	17	20	0	-300	30
250	315	0	-25	31	31	19	19	25	0	-350	35
315	400	0	-30	38	38	23	23	30	0	-400	40
400	500	0	-35	44	44	26	26	35	0	-450	45
500	630	0	-40	50	50	30	30	40	0	-500	50

**Table11. P6 Grade Self-aligning Bearing Outer Ring Tolerance (Except for Tapered Roller Bearings)**

表11 P6级向心轴承外圈公差（圆锥滚子轴承除外）

Unit:  $\mu\text{m}$

D(mm)		$\Delta\text{Dmp}$		Vdp				Vdmp	Kea	$\Delta\text{Cs}$		VCs
				Open		Close						
				Open 开型轴承	Close 闭型轴承	Open 开型轴承	Close 闭型轴承					
				Dia. Series								
				直径系列								
				9	0,1	2,3,4	0,1,2,3,4,5					
Over 超过	To 到	Up 上偏差	Down 下偏差		Max. 最大			Max. 最大	Max. 最大	Up 上偏差	Down 下偏差	Max. 最大
18	30	0	-8	10	8	6	10	6	9			
30	50	0	-9	11	9	7	13	7	10			
50	80	0	-11	14	11	8	16	8	13			
80	120	0	-13	16	16	10	20	10	18			
120	150	0	-15	19	19	11	25	11	20			
150	180	0	-18	23	23	14	30	14	23			
180	250	0	-20	25	25	15	-	15	25			
250	315	0	-25	31	31	19	-	19	30			
315	400	0	-28	35	35	21	-	21	35			
400	500	0	-33	41	41	25	-	25	40			
500	630	0	-33	48	48	29	-	29	50			
630	800	0	-45	56	56	34	-	34	60			
800	1000	0	-60	75	75	45	-	45	75			

Equals to  $\Delta\text{Bs}$  and  $\text{Vbs}$  of the same bearing inner ring.  
与同一轴承内圈的 $\Delta\text{Bs}$ 及 $\text{Vbs}$ 相同

### Radial internal clearance

径向游隙

**Table 1. Deep groove ball Bearings**

表1. 深沟轴承径向游隙

Unit:  $\mu\text{m}$

d mm		C2		C0		C3		C4		C5	
Over 超过	to 到	min	max	min	max	min	max	min	max	min	max
2.5	6	0	7	2	13	8	23	-	-	-	-
6	10	0	7	2	13	8	23	14	29	20	37
10	18	0	9	3	18	11	25	18	33	25	45
18	24	0	10	5	20	13	28	20	36	28	48
24	30	1	11	5	20	13	28	23	41	30	53
30	40	1	11	6	20	15	33	28	46	40	64
40	50	1	11	6	23	18	36	30	51	45	73
50	65	1	15	8	28	23	43	38	61	55	90
65	80	1	15	10	30	25	51	46	71	65	105
80	100	1	18	12	36	30	58	53	84	75	120
100	120	2	20	15	41	36	66	61	97	90	140
120	140	2	23	18	48	41	81	71	114	105	160
140	160	2	23	18	53	46	91	81	130	120	180
160	180	2	25	20	61	53	102	91	147	135	200
180	200	2	30	25	71	63	117	107	163	150	230
200	225	2	35	25	85	75	140	125	195	175	265
225	250	2	40	30	95	85	160	145	225	205	300
250	280	2	45	35	105	90	170	155	245	225	340
280	315	2	55	40	115	100	190	175	270	245	370
315	355	3	60	45	125	110	210	195	300	275	410
355	400	3	70	55	145	130	240	225	340	315	460
400	450	3	80	60	170	150	270	250	380	350	510
450	500	3	90	70	190	170	300	280	420	390	570
500	560	10	100	80	210	190	330	310	470	440	630
560	630	10	110	90	230	210	360	340	520	490	690
630	710	20	130	110	260	240	400	380	570	540	760
710	800	20	140	120	290	270	450	430	630	600	840
800	900	20	160	140	320	300	500	480	700	670	940
900	1000	20	170	150	350	330	550	530	770	740	1040
1000	1120	20	180	160	380	360	600	580	850	820	1150
1120	1250	20	190	170	410	390	650	630	920	890	1260

Ningbo Accor Machinery (Bearings) Co Ltd

Add: 4F, 675 Shiji Avenue, Jiangdong, Ningbo 315040, China

Ph: +86 574 87939850, 87939855

Fax: +86 574 87939860

E-mail: [accor@accormachinery.com.cn](mailto:accor@accormachinery.com.cn)

<http://www.accorbearings.com>, [www.accormachinery.com](http://www.accormachinery.com)