



## **One-way swivel bearing**

**POPULAR SIZE**



ACCOR MACHINERY [BEARING] CO.,LTD

CAT.NO.2011OCT

OW series one-way swivel ball bearings .....	2
OW系列单向球轴承	
One-way swivel drawn cup needle roller bearing.....	3-4
单向冲压滚针轴承	

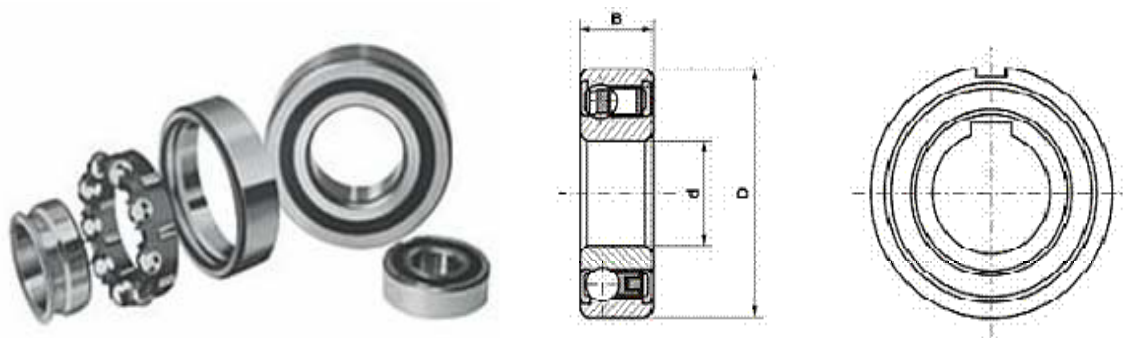

OW series one-way swivel ball bearing is the combination of the deep-groove ball bearing in standard external dimensions and the concealed type shaped roller one-way clutch, thus with strong function and compact structure, applicable to the use with the medium and small torques; ACCOR series shaped roller one-way clutch is composed of the inner and outer cages, strip spring and shaped roller. For it can hold more shaped rollers, it has the larger torque bearing capacity. Such clutch has no inner ring or outer ring, therefore its requirements of hardness, roughness and non-cylindricity etc of the working surfaces concerned of the seat bore and the shaft are higher. According to the users requirements, we may provide the components of shaped roller one-way clutch with inner and outer rings.

OW系列单向球轴承是由标准外形尺寸的深沟球轴承(6200系列)和异形辊子式超越离合器组合而成，其外型尺寸与62系列深沟球轴承相同，内部已填注润滑脂。根据用户需要,内、外圈可制作键槽，内圈制作键槽的型号为OW-P，内、外圈皆有键槽的型号为OW-PP。密封结构可分为开式和闭式两种结构，闭式代号OW-2RS。其具有结构紧凑和功能多的特点，适用于中、小扭矩和中、低转速场合。广泛应用于印刷机械、包装机械、食品机械、电动滚筒、减速机及测试设备等传递中。

Type	Bearings series	Dimensions(mm)			Nominal torque (N.m)
		d	D	B	
OW 12(2RS)	6201	12	32	10	10(6)
OW 15(2RS)	6202	15	35	11	30(23)
OW 17(2RS)	6203	17	40	12	48(35)
OW 20(2RS)	6204	20	47	14	60(50)
OW 25(2RS)	6205	25	52	15	80(70)
OW 30(2RS)	6206	30	62	16	100(85)
OW 35(2RS)	6207	35	72	17	123(110)
OW 40(2RS)	6208	40	80	22	260(240)

Note: 1. OW series one-way swivel ball bearings are equivalent to the CSK\*\* series of Germany STIEBER, ZZ62\*\* series of FAG and FK62\* \* series of GMN. 2. Fit: shaft n, seat hole N7

注：1.OW系列单向旋转球轴承相当于德国STIEBER公司CSK\*\*系列、FAG公司ZZ62\*\*系列、GMN公司FK62\* \*系列产品  
2.配合：轴n，座孔N7。

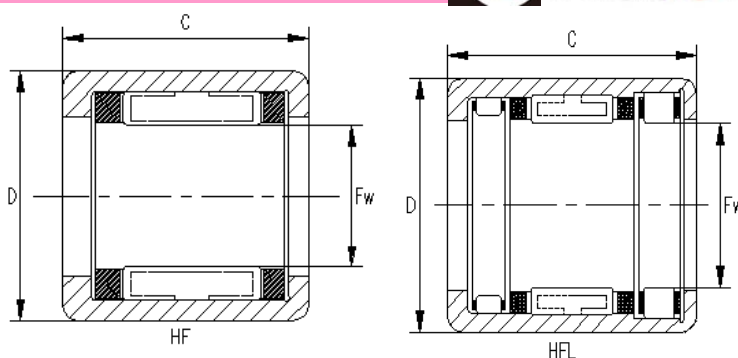

Shaft Diameter	Clutch Designation		Mass Approx	Boundary Dimensions			Torgue	Limiting Speed		Suitable Drawn Cup Bearings
	Plastic Springs	Steel Springs		Fw	D	C		Rotating Shaft Min-1	Rotatng Outer Ring Min-1	
mm			g	mm			Nm	rpm		
HF ( INA )										
3	HF0306KF		0.9	3	6.5	6	0.2	36000	7000	HK0306TN
4	HF0406KF	--	1	4	8	6	0.34	34000	8000	HK0408TN
	HF0406KFR	--	1	4	8	6	0.1	34000	8000	HK0408TN
6	HF0608KF		2.8	6	10	8	1.5	20000	11000	HK0608
	HF0612KF	HF0612	3	6	10	12	1.76	23000	13000	HK0608
	HF0612KFR	HF0612R	3	6	10	12	1.76	23000	13000	HK0608
		HF061210	3.5	6	12	10	3	20000	13000	HK061208
8	HF0812KF	HF0812	3.5	8	12	12	3.15	17000	12000	HK0808
	HF0812KFR	HF0812R	3.5	8	12	12	4	17000	12000	HK0808
	--	HF061210	3.2	8	12	10	3	16000	12000	HK0808
	--	HF081410	3.6	8	14	10	4.6	15000	11000	HK081410
	--	HF081610	4.1	8	16	10	5.5	15000	11000	HK081610
	--	HF081412	4	8	14	12	5	16000	12000	HK081410
10	HF1012KF	HF1012	4	10	14	12	5.3	14000	11000	HK1010
	HF1012KFR	HF1012R	4	10	14	12	1.5	14000	11000	HK1010
12	--	HF1216	11	12	18	16	12.2	11000	8000	HK1212
14	--	HF1416	13	14	20	16	17.3	9500	8000	HK1412
16	--	HF1616	14	16	22	16	20.5	8500	7500	HK1612
18	--	HF1816	16	18	24	16	24.1	7500	7500	HK1812
20	--	HF2016	17	20	26	16	28.5	7000	6500	HK2010
25	--	HF2520	30	25	32	20	66	5500	5500	HK2512
30	--	HF3020	36	30	37	20	90	4500	4500	HK3012
35	--	HF3520	40	35	42	20	121	3900	3900	HK3512

Note 1 : a one-way bushing maintain aircraft that are nylon materials ;KF maintain the springs to lift nylon materials without KF that springs to keep the stainless steel shelf;

Note 2:R expressed bearings to increase the bite to spend roll;

注1: 单向轴衬个保持架均为尼龙材质; KF表示保持架上的弹簧片为尼龙材质, 无KF表示保持架上的弹簧片为不锈钢;

注2: R表示轴承外圈滚花以增加咬合力;

One-way swivel drawn cup needle roller bearing

单向冲压滚针轴承

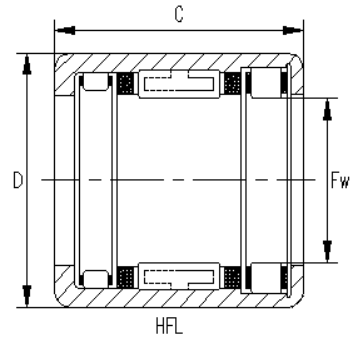
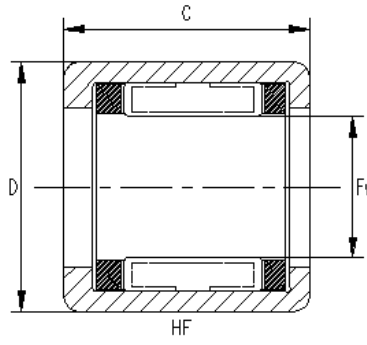

Shaft Diameter mm	Clutch Designation		Mass Approx g	Boundary Dimensions			Torgue Nm	Limiting Speed		Basic Load Ratings	
	Plastic Springs	Steel Springs		Fw	D	C		Rotating Shaft Min-1	Rotatng Outer Ring Min-1	C	Co
										KN	
HFL( INA)											
3	HFL0308	--	3	3	3.6	8	1	--	--	--	--
4	HFL0408	--	3.5	4	8	8	1.5	--	--	--	--
6	HFL0615KF	HFK0615	4	6	10	15	1.76	23000	13000	--	--
	HFL0615KFR	HFL0615R	4	6	10	15	0.5	23000	13000	--	--
	--	HFL061012K	5	6	10	12	--	21000	12000	--	--
8	--	HFL081212K	6	8	12	12	--	20000	12000	--	--
	--	HFL081412K	7	8	14	12	--	19000	12000	--	--
	HFL0822KF	HFL0822	7	8	12	22	3.15	17000	12000	4.05	4.15
	HFL0822KFR	HFL0822R	7	8	12	22	1	17000	12000	--	--
10	HFL1022KF	HFL1022	8	10	14	22	5.3	14000	11000	4.3	4.65
	HFL1022KFR	HFL1022R	8	10	14	22	1.5	14000	11000	--	--
12	--	HFL1226	18	12	18	26	12.2	11000	8000	6.3	6.5
14	--	HFL1426	20	14	20	26	17.3	9500	8000	7.1	7.7
16	--	HFL1626	22	16	22	26	20.5	8500	7500	7.7	9
18	--	HFL1826	25	18	24	26	24.1	7500	7500	8.3	10.3
20	--	HFL2026	27	20	26	26	28.5	7000	6500	8.9	11.5
25	--	HFL2530	44	25	32	30	66	5500	5500	10.9	14.1
30	--	HFL3030	51	30	37	30	90	4500	4500	12.6	17.6
35	--	HFL3530	58	35	42	30	121	3900	3900	13	19.3

Note 1 : a one-way bushing maintain aircraft that are nylon materials ;KF maintain the springs to lift nylon materials without KF that springs to keep the stainless steel shelf;

Note 2:R expressed bearings to increase the bite to spend roll;

注1：单向轴衬个保持架均为尼龙材质；KF表示保持架上的弹簧片为尼龙材质，无KF表示保持架上的弹簧片为不锈钢；  
注2：R表示轴承外圈滚花以增加咬合力；



Ningbo Accor Machinery (Bearings) Co Ltd

Add: 4F, 675 Shiji Avenue, Jiangdong, Ningbo 315040, China

Ph: +86 574 87939850, 87939855

Fax: +86 574 87939860

E-mail: [accor@accormachinery.com.cn](mailto:accor@accormachinery.com.cn)

[http:// www.accorbearings.com](http://www.accorbearings.com) , [www.accormachinery.com](http://www.accormachinery.com)